Reolink Firmware Upgrade Guide

Applies to: Reolink RLC-1210A

Firmware for hardware version IPC_523128M12MP

If your model is not listed above or the hardware version of your camera is not the exact number listed above, please do not upgrade this firmware. If you upgrade wrong firmware, it may brick your camera.

Attention for firmware upgrade:

- If you don't want to restore your camera settings to factory status, please uncheck the "Update Configuration Files" option during the upgrade.
- During the upgrading procedure, please do not power off the camera.
- Make sure your camera has the correct model and hardware version listed above, otherwise, please do not upgrade this firmware.

1. Check your current camera firmware version.

To ensure you upgrade the correct firmware, please check your camera model on the product sticker or System Information page via Reolink App or Reolink Client software.

On Reolink App, tap on the gear icon to go to the **Device Settings** page. Slide the screen to the top, then click on camera, and then you will find the **Device Info** of your camera.



On Reolink Client,click **Device Settings** button then click **Info** icon.

Settings

- Camera
 - Display
 - Stream
 - Detection
 - Audio and Light
 - Info**
- Surveillance
- Network
- Storage
- System

Info



Camera Name	423
Model	RLC-423
UID	95270000MZ
Build No.	build 20103109
Hardware No.	IPC_51516M5M
Config Version	v3.0.0.0
Firmware Version	v3.0.0.116_20103109
Details	IPC_51516M5MS10E1W01100000001

At the Information page, please ensure your camera model is correct, and the Hardware version is IPC_51516M, so you can upgrade this firmware.

To read the camera's firmware version via Build No, for example build 20080412, the larger the numbers are the newer the firmware is.

2. Upgrade steps.

Take Reolink Client (Windows) for example:

Step 1: Launch Reolink Client and log in to your camera, then go to **Device Settings -> System -> Maintenance** page.

Step 2: Tap on **Browse** to select the correct upgrade file **xxx**, then click **Upgrade** to start upgrading firmware.

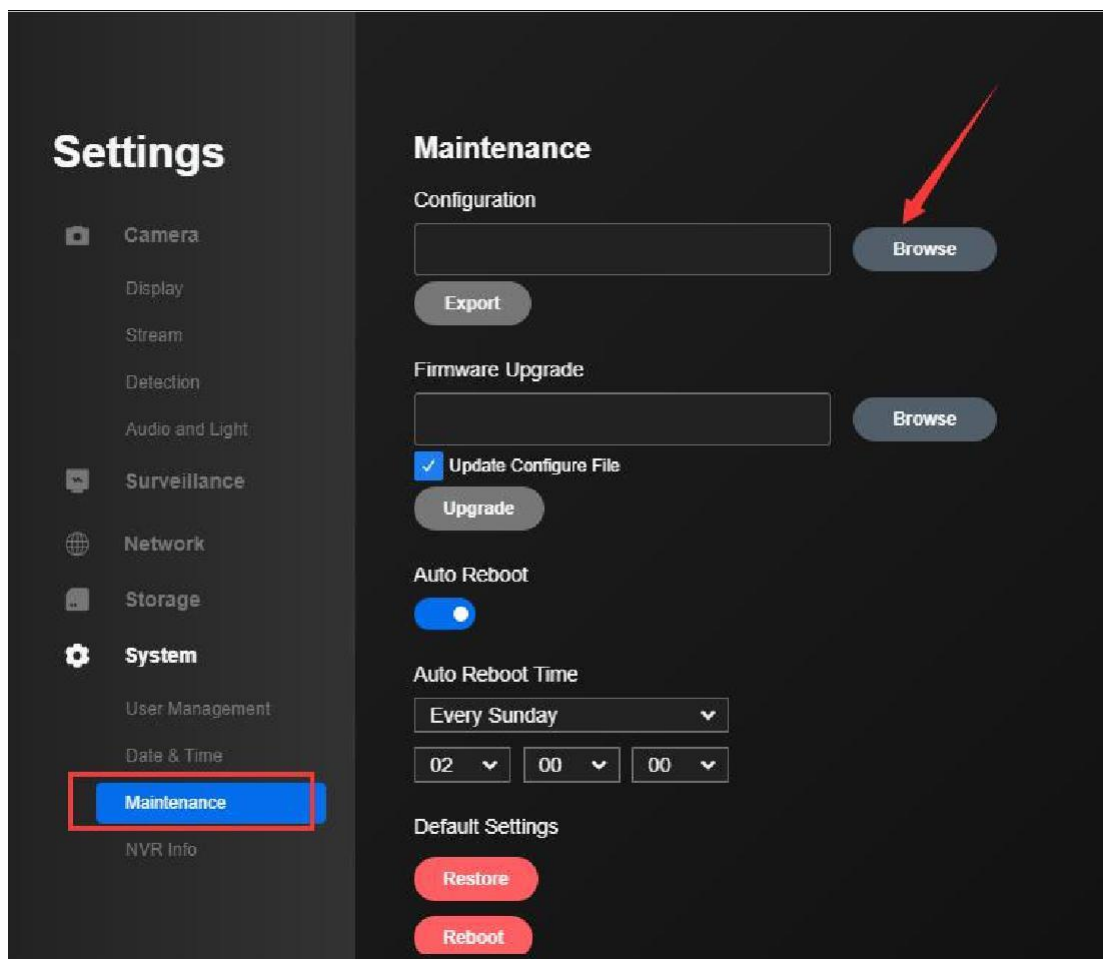

Note:

If you don't want to restore your camera settings to factory status, please uncheck the "Update Configuration Files" option.

During the upgrading procedure, please do not power off the camera.

For more upgrade guides on other software platforms, please read:

<https://support.reolink.com/hc/en-us/articles/360008743073-How-to-Upgrade-the-Firmware-for-Reolink-Products>